



GOLDEN EAGLE LUXURY TRAINS

VOYAGES OF A LIFETIME BY PRIVATE TRAIN™

# Ancient China by Private Train

2026 DEPARTURES





For 35 years, Golden Eagle Luxury  
Trains has been at the forefront  
of extraordinary rail journeys,  
combining a passion for discovery  
with unparalleled elegance.







Observation Car

## The Golden Eagle Silk Road Express

Experience the rich tapestry of cultures, history, and landscapes from the comfort of our opulent train.



The Golden Eagle Silk Road Express offers a truly luxurious journey



Bar Lounge Car



Let the *Golden Eagle Silk Road Express* transport you across centuries of civilisation, while indulging in the finest of travel experiences. Step aboard and experience unparalleled comfort with our thoughtfully designed onboard facilities.





# Your On Board Accommodation

Life aboard the *Golden Eagle Silk Road Express*

Step into a world of opulence aboard the *Golden Eagle Silk Road Express*, where every detail of your accommodation has been crafted to offer the ultimate in luxury.

Choose from two elegantly designed cabin classes: the Superior Cabin, configurable as a twin or double bed, or the Han Dynasty Suite, where lavish comfort takes centre stage.



Each cabin blends the ornate design of the Orient with the grandeur of a bygone era, providing an exquisite home as you embark on a luxurious journey by private rail.

Embark on an extraordinary journey aboard the *Golden Eagle Silk Road Express*, where ancient routes of the Silk Road meet the epitome of modern luxury.

Turn overleaf to discover more about the refined elegance awaiting you onboard.





# Superior Cabins

The Superior Cabins on the *Golden Eagle Silk Road Express* offers an elegant retreat, blending comfort and style across 11m<sup>2</sup> of thoughtfully designed space.

By day, relax in two single sofas, perfect for unwinding as you take in the scenery. By night, the cabin transforms into your choice of twin single beds or a double bed for restful slumber. Every detail has been curated for your comfort, with features including a Dyson hairdryer, smart toilet, mini bar, full-length wardrobe, and a cosy sofa chair. A 2.5m<sup>2</sup> en-suite bathroom completes the experience, offering modern luxury within a setting of timeless elegance.



DOUBLE CABIN  
DAY LAYOUT

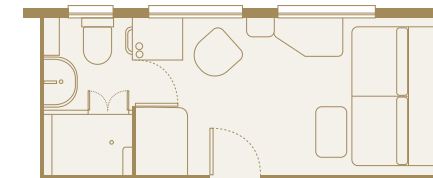

TWIN CABIN  
DAY LAYOUT

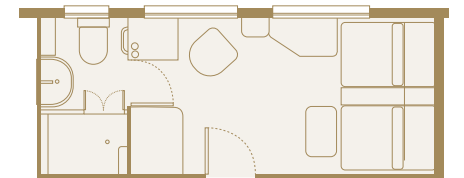

DOUBLE CABIN  
NIGHT LAYOUT

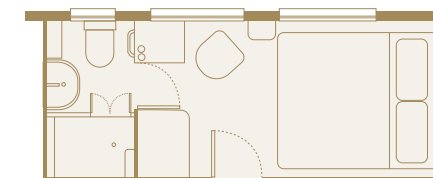

TWIN CABIN  
NIGHT LAYOUT

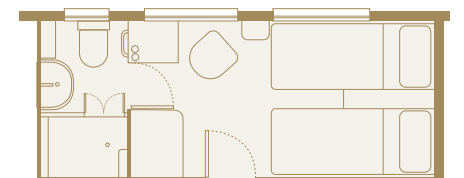

## Superior Cabins Specification

- Sleeps 1 or 2 with either 2 Single Beds (190cm x 75cm) or 1 Double Bed (190cm x 170cm)
- Cabin Size 11m<sup>2</sup> (535cm x 205cm)
- Wardrobe (80cm x 70cm x 202cm)
- Single Sofa Chair
- Individually controlled air conditioning and heating
- Built in minibar and fridge
- Recessed lighting and wardrobe
- Personal safe
- Private en-suite bathroom with TOTO smart toilet, full power shower and underfloor heating
- Bathrobes, slippers, Dyson hairdryer and luxury toiletries provided
- Towels and linens changed every second day or daily on request
- Complimentary tea, coffee and mineral water in cabin available at all times
- Drinks in the Bar Lounge Car included
- Laundry service available at an additional charge



# Han Dynasty Suite

The Han Dynasty Suite on the *Golden Eagle Silk Road Express* is the epitome of luxury travel, offering an expansive 22.2m<sup>2</sup> cabin designed to provide the ultimate in comfort and elegance.

Featuring a double bed and a double sofa, this Suite invites you to unwind in your own private sanctuary as you journey through the heart of the ancient Silk Road.

With a separate living room, a dressing table, and a dining table for private in-cabin dining, every detail has been thoughtfully crafted to ensure a truly indulgent experience. The 5.2m<sup>2</sup> en-suite bathroom features a bathtub, shower, and double sinks, combining modern convenience with timeless opulence.

Premium amenities, including a Dyson hairdryer, smart toilet, mini bar, and full-length wardrobe, ensure your every need is met as you travel in unparalleled style.

The Han Dynasty Suite is more than just a cabin – it is a luxurious retreat, offering a perfect blend of space, sophistication, and privacy, designed for those who appreciate the finer things in life.

## A note for Han Dynasty Suite Guests

A private guide and chauffeured car service is included in many of the destinations we visit on your journey, however, in remote locations where there are a limited number of experienced and qualified tour guides available, we may offer a shared car service among Han Dynasty Suite guests.

Han Dynasty Suite guests will also benefit from laundry service and room upgrades to the next available category at the hotels which are featured in the itinerary.

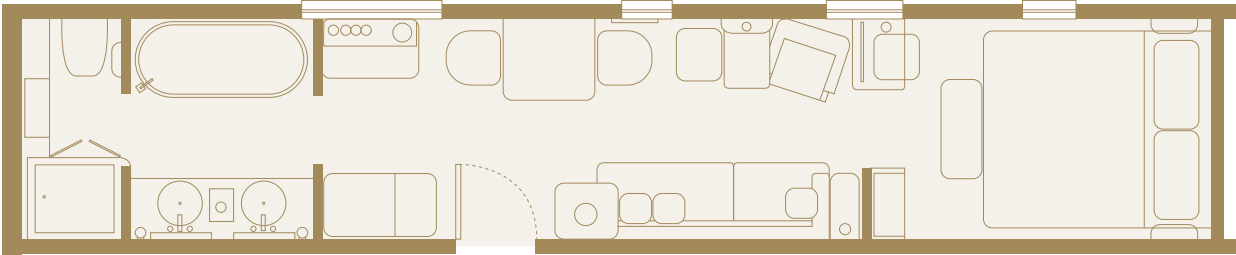

## Han Dynasty Suite

- Sleeps 2 in a Double Bed (190cm x 170cm)
- Separate living room (475cm x 205cm) with double sofa
- Individually controlled air conditioning and heating
- Recessed lighting and wardrobe
- Dressing table
- Dining table
- Personal safe
- Closet 62cm x 35cm x 204.5cm
- Private en-suite bathroom (5.2m<sup>2</sup>) with TOTO smart toilet, deluxe bathtub and double sink
- Bathrobes, slippers, Dyson hairdryer and luxury toiletries provided
- Complimentary built-in minibar and fridge
- Hermes tissue box, tray, tea bag box
- Laundry service included
- Towels and linens changed every second day or daily on request
- Complimentary tea, coffee and mineral water in cabin available at all times
- In-cabin dining available on request
- Complimentary drinks from the Bar Lounge Car included
- Private car and guide options in selected cities for off-train excursion programme







## Dining On Board

Welcome to the *Golden Eagle Silk Road Express*, where cuisine and service combine to offer an unparalleled dining experience.

Our commitment to culinary excellence ensures that each dining experience aboard the *Golden Eagle Silk Road Express* is world-class, both in flavour and in service. With two distinct restaurant cars designed by the globally renowned Hirsch Bedner Associates (HBA), our dining spaces offer a refined ambience that enhances the pleasures of every meal.

Each dining experience on the *Golden Eagle Silk Road Express* is a celebration of elegance. Our restaurant cars are adorned with vintage British silverware, complemented by the finest French Alain Saint-Joani silver cutlery and exquisite Nachtmann glassware from Germany.

These thoughtful touches elevate every meal, transforming it into a moment to be savoured. Every fork, every glass, every detail has been selected to ensure that dining on board is an event in itself – a unique occasion that enriches your journey.

Our menus are crafted to reflect both Western culinary tradition and local influences, offering guests the opportunity to savour classic dishes while also indulging in the regional flavours of the Silk Road.

With ingredients sourced fresh from local markets and selected for the finest provenance, every bite offers a taste of the destinations we traverse. Whether it's a perfectly prepared Western dish or an authentic local delicacy, your culinary journey will be as memorable as the landscapes you travel through.

From the moment you step aboard, our highly trained staff are dedicated to anticipating your every need. With the hallmark of five-star service, we cater to all dietary requirements and requests, ensuring that your experience is as personalised as it is luxurious.

Our staff are our family, and they are wholly committed to making your voyage aboard the *Golden Eagle Silk Road Express* as exceptional and seamless as possible.

On board, every meal is more than just a pause in your journey – it is an opportunity to connect deeply with the culture, the landscape, and the stories that make our itineraries truly remarkable.





## A Culinary Voyage

At Golden Eagle Luxury Trains, we believe that cuisine lies at the very heart of a culture, and through each exquisite dish, we offer our guests an authentic journey to the souls of the destinations we visit.



### WESTERN INSPIRED RESTAURANT

Our Western-style restaurant car, with its sophisticated yet warm atmosphere, offers the option for banquet dining, perfect for celebrating the richness of a shared voyage.

Here, five-star service meets silver-service tradition, with steward service and liveried wait staff committed to delivering an impeccable experience. Whether you are dining alone or in the company of fellow travellers, each moment is tailored to your desires.



### CHINESE INSPIRED RESTAURANT

For those who prefer a more intimate setting, our Chinese-style restaurant car offers booth seating with an ambience of elegance and serenity.

Designed to reflect the local culture, this space provides an authentic backdrop for tasting the finest local dishes, meticulously prepared by our expert chefs.



On the *Golden Eagle Silk Road Express*, one of the elegant restaurant cars can be reconfigured into a stunning Banquet-Style dining setting, perfect for creating unforgettable moments.

On selected journeys, guests are invited to a celebratory Gala Dinner, an extraordinary event that encapsulates the spirit of the voyage. This special evening offers the chance to toast newfound friendships, reflect on the remarkable journey, and celebrate in style. Surrounded by opulent décor and exquisite cuisine, the Banquet-Style dining experience elevates the adventure, ensuring every guest departs with cherished memories of an extraordinary, luxurious adventure.





# Bar Lounge Car

The Bar Lounge Car aboard the *Golden Eagle Silk Road Express* is a masterpiece of timeless elegance

A place where history and modern craftsmanship blend seamlessly to create an unforgettable social space.

Enter through its innovative double-door entry, inspired by the graceful curves of Han Dynasty chariots, and step into an expansive, refined setting designed for elegant gatherings.

At the heart of the Bar Lounge Car is a world-renowned Bösendorfer piano, setting the tone for sophisticated evenings, while artistic rarities and antique silverware offer a glimpse into the past.

Each detail, from the exquisite design to the spacious layout, is crafted to



evoke luxury, creating an exclusive setting where guests can indulge in fine conversation and captivating performances.

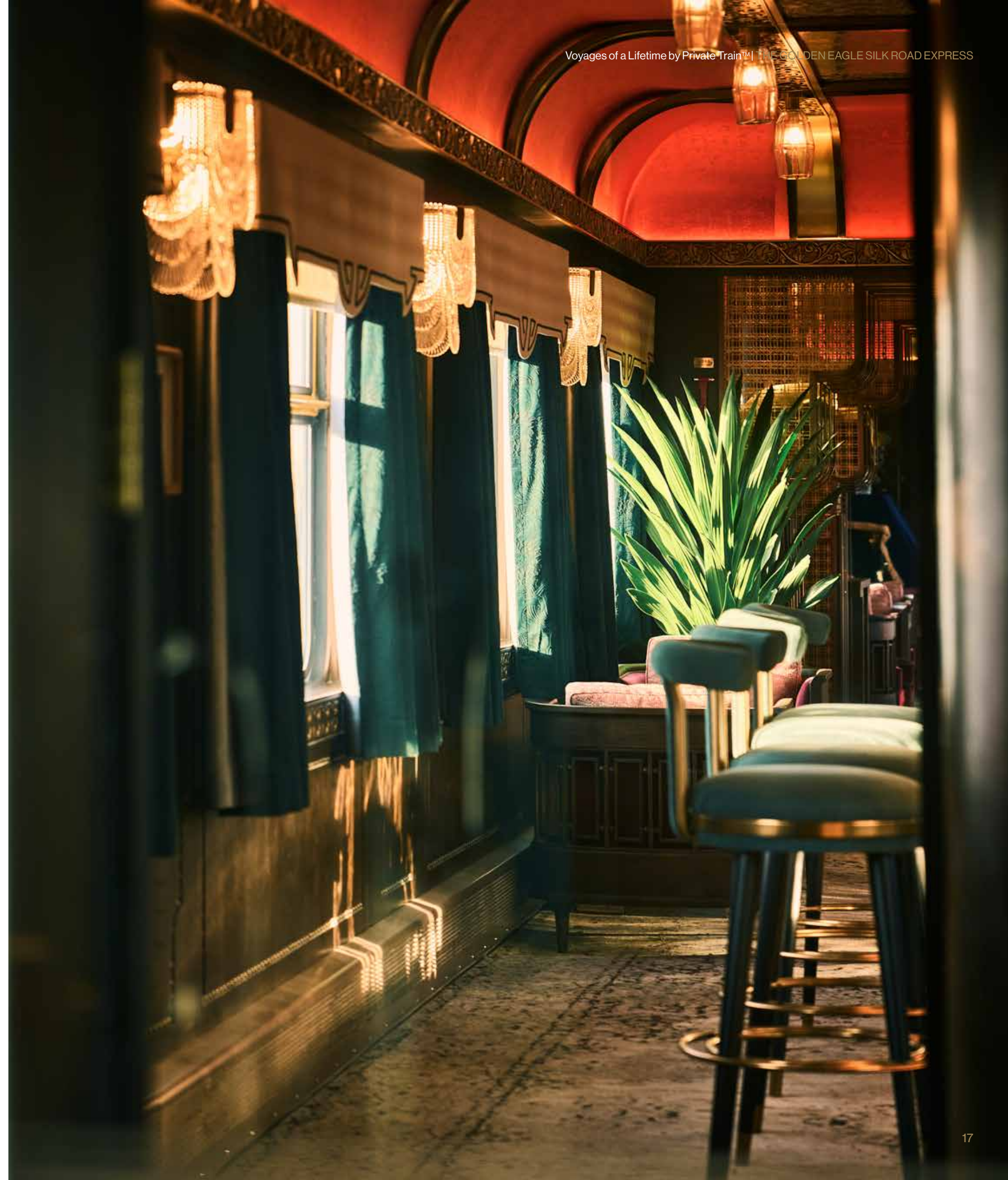





# Observation Car

Featuring a stunning 270° panoramic window, this exquisite space breaks the boundary between the train and the breathtaking landscapes, allowing guests to effortlessly capture the ever-changing scenery from the soft hues of morning light to the golden glow of evening twilight.

With intricate wooden carvings and soft internal lighting, the walls evoke the rich history of ancient Chang'an, offering a dazzling display of the map and cityscape of the ancient Silk Road. Onboard private charters, the flexibly designed partitions can create an exclusive four-person reception room, perfect for intimate gatherings.



The Observation Car aboard the *Golden Eagle Silk Road Express* offers an unrivalled connection between nature and luxury.



Experience the remarkable blend  
of ancient culture and natural  
wonders along these legendary routes.

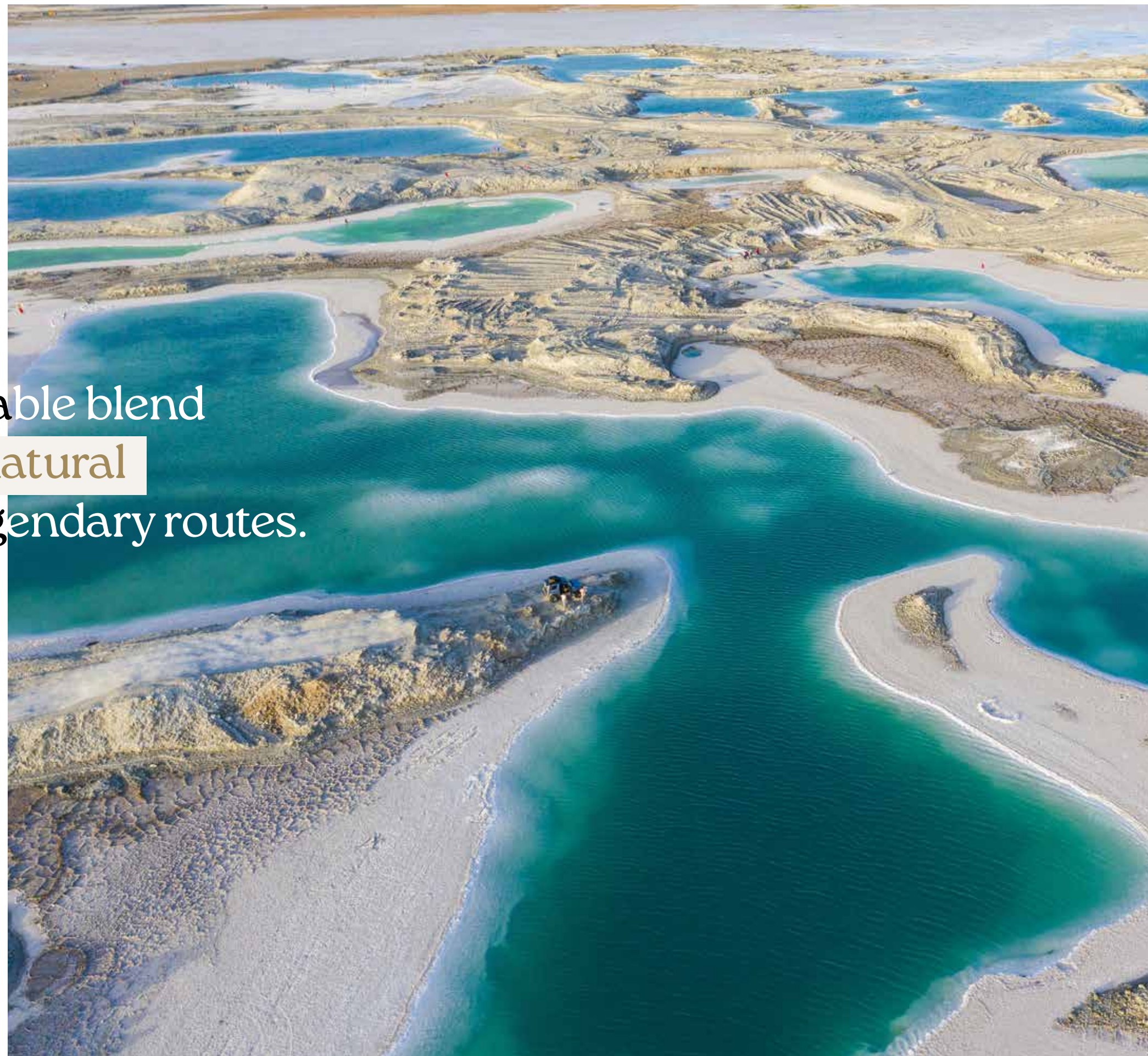



# Ancient China by Private Train

BEIJING • XI'AN • DUNHUANG • GOLMUD • HOTAN • KASHGAR • TURPAN • URUMQI



Embark on an unforgettable journey through the heart of ancient China, where history, culture, and natural beauty converge on an extraordinary route aboard the *Golden Eagle Silk Road Express*.

This exclusive voyage traverses a captivating landscape of imperial capitals, desert oases, and ancient cities, transporting guests through Beijing, Xi'an, Dunhuang, Hotan, Kashgar, and beyond.

Along the way, you'll encounter the awe-inspiring Terracotta Warriors, walk the revered Great Wall, and explore the majestic Mogao Caves – a UNESCO World Heritage Site adorned with exquisite Buddhist art.

On board the *Golden Eagle Silk Road Express*, experience unparalleled luxury with spacious en-suite cabins, world-class cuisine, and refined service.

From the floor-to-ceiling windows of the observation car, take in sweeping vistas of China's diverse landscapes – from the verdant valleys surrounding Xi'an to the ethereal sands of the Gobi Desert.

At each stop, expert guides bring each site to life, sharing tales of emperors, traders, and pilgrims who once journeyed along these fabled paths.

This immersive, meticulously curated expedition promises a luxurious and enriching adventure into China's timeless heritage.



## Map Key

-  The Silk Road
-  Notable stop
-  **BEIJING** Tour start / end location
-  Other railway lines
-  International boundary
-  City / Town
-  Rivers
-  Lakes

## Day by Day Schedule

- DAY 1** Beijing
- DAY 2** Beijing
- DAY 3** Beijing & On Board Golden Eagle Silk Road Express
- DAY 4** Xi'an
- DAY 5** On Board
- DAY 6** Dunhuang
- DAY 7** Golmud
- DAY 8** Hotan
- DAY 9** Kashgar
- DAY 10** Turpan
- DAY 11** Turpan & Urumqi
- DAY 12** Urumqi

## Tour Includes

- 2 nights in Beijing
- 8 nights on board the Golden Eagle Silk Road Express
- 1 night in Urumqi

## Tour Dates

September 21 - October 2, 2026

DEPOSIT REQUIRED		\$3,000		\$6,000	
			SUPERIOR CABINS		HAN DYNASTY SUITE
			TWIN/DOUBLE	SINGLE	DOUBLE SINGLE
September 21, 2026	October 2, 2026		\$18,500	\$30,900	On Request On Request





**1 Beijing**  
Monday, 21 September

Upon arrival in Beijing, guests will be warmly welcomed and transferred in luxury to the prestigious Four Seasons Beijing, where a three-night stay awaits in the epitome of five-star comfort. That evening, join fellow travellers for an exclusive welcome reception and dinner, setting the tone for an exceptional journey along the Silk Road.

**2 Beijing**  
Tuesday, 22 September

Our adventure begins with a morning visit to the Great Wall at Badaling, one of the most iconic symbols of ancient China. Here, guests can walk along a beautifully restored section, soaking in the breathtaking views and imagining the historical figures who once guarded this marvel. In the afternoon, enjoy leisure time to explore Beijing's lively mix of ancient traditions and modern vibrancy.

That evening, we gather for a sophisticated dining experience at a celebrated Peking Duck restaurant. This Beijing speciality, cherished for centuries, is expertly prepared and carved at your table, offering a delectable insight into Chinese culinary mastery.

**3 Beijing**  
Wednesday,  
23 September

Today, a comprehensive tour of Beijing's historic heart reveals the grandeur of China's ancient dynasties.

Explore the Forbidden City, the sprawling imperial palace where emperors ruled for nearly 500 years. Stroll through Tiananmen Square, a place of great historical significance, before discovering the Summer Palace, a serene retreat adorned with beautiful gardens, temples, and lakes.

Alternatively, delve into Beijing's modern allure with a tour of contemporary landmarks: marvel at the architectural feats of the Olympic Village and the iconic "Bird's Nest" Stadium, glimpse the striking design of the CCTV Tower, and explore the National Museum for a modern-day perspective on China's cultural evolution.

In the evening, we board the *Golden Eagle Silk Road Express*, our luxurious home for the next leg of the journey. Settle into your elegant suite before enjoying a welcoming dinner in the dining car, as we begin our journey westward in true comfort.



**4 Xi'an**  
Thursday, 24 September

In Xi'an, we explore the ancient city walls and the historic Great Mosque, one of China's oldest and largest mosques, blending Islamic and Chinese architectural styles. Later, we visit the awe-inspiring Terracotta Army – a life-sized army of soldiers, chariots, and horses, buried with China's First Emperor to protect him in the afterlife. This UNESCO site, often hailed as the Eighth Wonder of the World, offers a mesmerising insight into ancient Chinese beliefs and artistry.

In the evening, delight in an authentic Tang Dynasty dinner, where the ambiance is enhanced by a captivating performance of traditional music and dance, evoking the grandeur of ancient Xi'an.







5

## On Board Friday, 25 September

Today is a day of leisure as we traverse the Chinese landscape aboard the *Golden Eagle Silk Road Express*. Take in the panoramic scenery from the observation car's floor-to-ceiling windows, the largest of any train in China, or unwind in the bar car with a selection of fine wines and spirits.

6

## Dunhuang Saturday, 26 September

Arriving in Dunhuang, we explore the Mogao Caves, a UNESCO World Heritage Site famed for its ancient Buddhist art.

This "Cave of a Thousand Buddhas" is a spiritual oasis that has inspired pilgrims and artists for centuries, adorned with vibrant murals and statues that date back over a thousand years. Local folk artists serenade us with music, adding

an atmospheric touch to our journey through this sacred complex.

After a delightful lunch, we embark on a camel trek along the Silk Road to the enchanting Crescent Lake, an oasis nestled among towering dunes. This tranquil crescent-shaped lake has endured millennia of desert winds and remains a cherished symbol of resilience and beauty.

7

## Golmud Sunday, 27 September

Our day in Golmud includes an enlightening lecture at the Hilton Qinghai-Golmud on the Silk Road's history, highlighting its role as a bridge between East and West.

Guests may choose to explore the Chaerhan Salt Lake, a surreal landscape of salt flats and mineral deposits, or enjoy a guided tour through Golmud's vibrant city streets, before we re-board the train.



8

## Hotan Monday, 28 September

Enjoy a leisurely morning on board before an exclusive visit to Hotan's Atlas Silk and Carpet Workshop.

Here, witness master artisans create intricate silk fabrics and carpets using time-honoured techniques passed down through generations. In the evening, we step back in time with a tour of Yotkan Ancient City. Once the heart of the Buddhist Kingdom of Khotan, this ancient city flourished along the Silk Road, its temples and cultural centres revealing Hotan's rich legacy as a nexus of trade and spirituality.



9

## Kashgar Tuesday, 29 September

Today, we delve into Kashgar, a city that has long been a melting pot of cultures, religions, and architecture. Begin with a visit to the Apak Khoja Tomb, a stunningly adorned mausoleum considered the holiest Muslim site in Xinjiang. Wander through the Old Town, where narrow alleys and traditional homes provide a glimpse into local life, and explore the Gaotai folk houses, an area steeped in history and tradition.

A delightful lunch in a local restaurant introduces us to the diverse flavours of Uyghur cuisine before we return to the train to continue our westward journey.







**10** **Turpan**  
Wednesday, 30  
September

Arriving in Turpan, we explore the Ancient City of Gaochang, an ancient Silk Road outpost that once served as a vital trading hub. After lunch, we marvel at the Karez irrigation system, an engineering marvel that has provided water to this arid region for centuries. We then visit Jiaohe Ruins, an ancient city carved from rock, whose unique architecture reflects the ingenuity of its former inhabitants.

In the evening, join us for a final dinner aboard the train as we bid farewell to the *Golden Eagle Silk Road Express*.

**11** **Turpan & Urumqi**  
Thursday, 1 October

After a restful morning on board, join a captivating lecture exploring the legacies of the Silk Road.

Following a leisurely lunch on board, we disembark in Urumqi, where we'll enjoy an overnight stay.

This city is the cosmopolitan capital of Xinjiang, home to numerous ethnic groups and brimming with the vibrant energy of East meets West.

**12** **Urumqi**  
Friday, 2 October

On your final morning, our team will assist with transfers to Urumqi's international airport for your onward journey.

Leaving with memories of China's treasures and the unforgettable sights of the Silk Road, we hope your journey has been as extraordinary as the history of the lands you have traversed.





# Important Information about our Tours



## WHAT IS INCLUDED IN THE PRICE?

All accommodation as per the itinerary; both on board the train and in hotels; all meals starting with dinner on the first day; with all hot, cold and alcoholic drinks included on and off the train; all arrival and departure transfers; guided off-train sightseeing excursions; the services of experienced tour leaders; complimentary tea, coffee and bottled water 24 hours a day, all gratuities; and in most cases a doctor travelling with the group.

## WHAT IS NOT INCLUDED IN THE PRICE?

International and domestic airfares (unless stated as part of the itinerary); visa and excess baggage charges; travel and medical insurance. Personal expenses such as laundry. On some tours there may also be an occasional optional activity that needs to be paid for locally.

## PASSPORT AND VISA INFORMATION

It is your responsibility to be in possession of a valid passport and visa for your trip. A passport with a minimum validity of 6 months

is required for all our rail tours. Many of the remote and exotic countries we visit require visas. Visa costs are not included in the price of the tour and these must be purchased independently. This can often be an involved and time-consuming process and, as this is such an important aspect of your holiday, we can assist you with advice and any supporting documentation.

Detailed visa advice, specific to your nationality, is issued approximately 4 months prior to departure. We do not take any responsibility for any passengers in possession of incorrect or invalid visas.

Please contact our Customer Services department for help and information. For customers in the United Kingdom we can put you in contact with our recommended visa support agency.

## ACCESS TO WI-FI

On the *Golden Eagle Silk Road Express* there is a Wi-Fi box on board, powered by a 4G

sim. Coverage is limited and will usually be available as we pass through larger cities/towns. However, on all tours we aim to provide internet access in a local hotel or restaurant for passengers at least every other day.

Our Tour Manager will keep you informed of all the opportunities to use Wi-Fi and provide password access when necessary.

## INSURANCE

It is a booking condition that you must be fully insured for any medical expenses that may be incurred whilst travelling. For UK passengers comprehensive travel insurance policies can be obtained from Campbell Irvine.

## VACCINATIONS

As our rail journeys visit areas of developing countries, we strongly advise that you consult your doctor or a medical centre for specific health advice.

## ON BOARD DOCTOR

We provide a doctor on board all our tours who is available for emergency medical situations 24 hours a day.

They carry a fully stocked medical kit but it is your responsibility to ensure that you obtain any vaccinations, prescribed and precautionary medicine for the countries you are visiting before travelling with us.

## INTERNATIONAL & DOMESTIC FLIGHTS

Flights are not included (unless part of the itinerary) but we can advise fares.

Please note that we do not advise that you book flights more than 60 days in advance of the tour departure date (see Booking Conditions).

## HOTEL ACCOMMODATION

Hotel accommodation as described in the tour itinerary is included in the price of the tour. All hotels are of a 5-star standard or best available. Room upgrades are available on request, subject to availability and at an additional cost.

## ITINERARIES

Accommodation and tour itineraries, including the provision of guest speakers and steam haulage, are subject to change at any time due to circumstances beyond our control. Every effort will be made to operate tours as advertised and as per the rail timings received.

## SPECIAL REQUESTS

We pride ourselves on offering you a personalised and knowledgeable service and will make every effort to meet any of your special dietary, room or travel requests. Also we are very happy to cater for any special occasion or anniversary that you are celebrating whilst you are with us. Please advise us at the time of booking.

## SINGLE TRAVELLERS

Many of our guests are single travellers and of course passengers travelling as small groups, families, couples or singles are all equally welcome.

## GRATUITIES

All gratuities are included in the tour price and we strongly encourage passengers to refrain from offering gratuities to crew/hoteliers/drivers etc. We would prefer passengers to inform our management of any exceptional service received, and we will reward accordingly.

## LANGUAGE

The primary tour language will be English. Please contact us for more information.

## MEETING POINTS

Details of hotel/airport meeting points will be printed on the tour vouchers and departure packs that will be sent to you one month prior to departure.

## TRAVELLER HEALTH CONDITIONS

To get the most out of our tours, passengers must be able to walk at least a mile per day at normal walking speed. The traveller confirms that neither he/she has any physical or mental condition or disability that could create a hazard to him/herself or other members of the tour.

We reserve the right to refuse travel to anyone who, in the opinion of the tour doctor or tour manager would be incapable of completing the tour or would cause unacceptable delays to the rest of the group. In these circumstances there would be no refund for any unused part of the tour.

We also reserve the right to reclaim any costs incurred as a result of providing additional services to cater for their mobility needs e.g. a wheelchair. If in doubt, please call us for advice.

## BOOKING CONDITIONS

Our full booking conditions can be found on [www.goldeneagleluxurytrains.com](http://www.goldeneagleluxurytrains.com)

## TRAVEL INSURANCE

We believe that your safety and holiday enjoyment are very important, therefore travel insurance is a must whenever you travel abroad.







## What's Included in the Tour Price

As far as possible our tours are all-inclusive with no hidden extras. What follows are all those elements which are included in the tour price.

The only extra items you may need to budget for include personal expenses such as International and Internal flights that are not included in the itineraries, visa costs, insurance and laundry.

### EXPERIENCED TOUR MANAGERS

Our experienced Tour Managers are selected for their travel knowledge, and their linguistic and organisational abilities allowing you to relax and enjoy your rail cruise.

We receive exceptional passenger comments about our Tour Managers and their aim is to ensure you enjoy every minute of your holiday.

### ARRIVAL & DEPARTURE AIRPORT TRANSFERS

Arrival and departure transfers are included.

### HOTEL AND ON BOARD ACCOMMODATION

Although you will spend much of your time sightseeing or relaxing in the train's public areas, you will find your cabin a welcome retreat at the end of a rewarding day. All hotels are of five-star standard, or the best available.

### ON BOARD DOCTOR AND MEDICAL FACILITIES

To give you peace of mind our tours are accompanied by a doctor who travels with us for the entire journey; so you can rest assured that medical assistance is always available. On call 24 hours a day, the doctor is on hand to give primary care as required. In almost every case, the doctor will be English-speaking and registered with the General Medical Council in the UK.

### BREAKFAST, LUNCH AND DINNER DAILY

All meals are included, starting with dinner on the first day and ending with breakfast on the last day. All departures feature one or two uniquely designed Restaurant Cars where you can enjoy the excellent waiter-served food and wine. Several times during the tour we will also sample authentic local cuisine with wine and a selection of drinks off the train, which is also included in the tour price.

### DRINKS WITH MEALS

A generous drinks allowance, both alcoholic and non-alcoholic, is included with lunch and dinner on and off the train.

### ON BOARD SERVICE

You can expect service which is attentive, friendly and unintrusive. Your car attendants provide 24-hour housekeeping and bedding turndown services, with one attendant always on duty to assist you and to ensure you are comfortable in your cabin. Complimentary tea, coffee and bottled drinking water are available in your cabin 24 hours a day.

### LUGGAGE HANDLING

As you only have to unpack once your luggage and belongings will stay with you on the train throughout the journey but, wherever necessary, portage is included between the hotels and stations.

### GUIDED OFF-TRAIN EXCURSIONS

The history and culture of the places we visit on our rail cruises will come alive through our expert local guides.

All our tours include a wide-ranging sightseeing schedule to make the most of the time you have off the train and bring you closer to the culture, people and history of your destinations.

We believe it is the special little touches that help create magical memories.

### PERSONAL HEADSETS

On all the off-train excursions, to enhance your enjoyment and insights into the places you visit, you will be provided with a lightweight personal headset on which to listen to your tour guide as you take in the sights.

The range of the headset means that you do not need to worry about missing any of the guide's commentary on your excursion, even if you prefer to wander away from the group.

### ALL GRATUITIES

You will not have to worry about tipping on or off the train on your rail journey with Golden Eagle Luxury Trains as all gratuities are included in the tour price.